



TClinic

11

ELECTRICAL SYSTEM—SUPPLEMENTAL STOP-TAIL LIGHT

Had a good look at your tail lights! From about 10 car lengths to the rear dark night, at about 65 mph on a freeway. If you are using only the original "D" you'll find it is hopelessly inadequate. The first thing to do is to take it apart and clean it thoroughly. Then replace the bulbs. They darken with age. After doing this you will still find that they leave something to be desired. A very good addition to the lighting system has been suggested by Goodman. He places a large diameter lens and a bracket attached to the spare wheel mounting. The light will shine through the spot which is far from being "original" on the car, but being able to be seen from the rear traffic. If the bracket is made properly and the wiring is neatly done, it is very useful.

Make the bracket of 1" flat stock, with a long horizontal bar filed off to conform to the spare wheel mounting. Cut it to the desired length and fasten—weld if possible—to the horizontal piece. Drill the necessary holes and coat with primer and then paint to match the car. A lens can be purchased from any hardware store. Be sure and ask for a single lens, 12 volt dual filament type. They cost about \$5.00. Before placing the light on the bracket, paint the inside of it white. This increases its reflectivity. Please note that this complete assembly mounts on the back (next to the gas tank) of the spare wheel carrier.

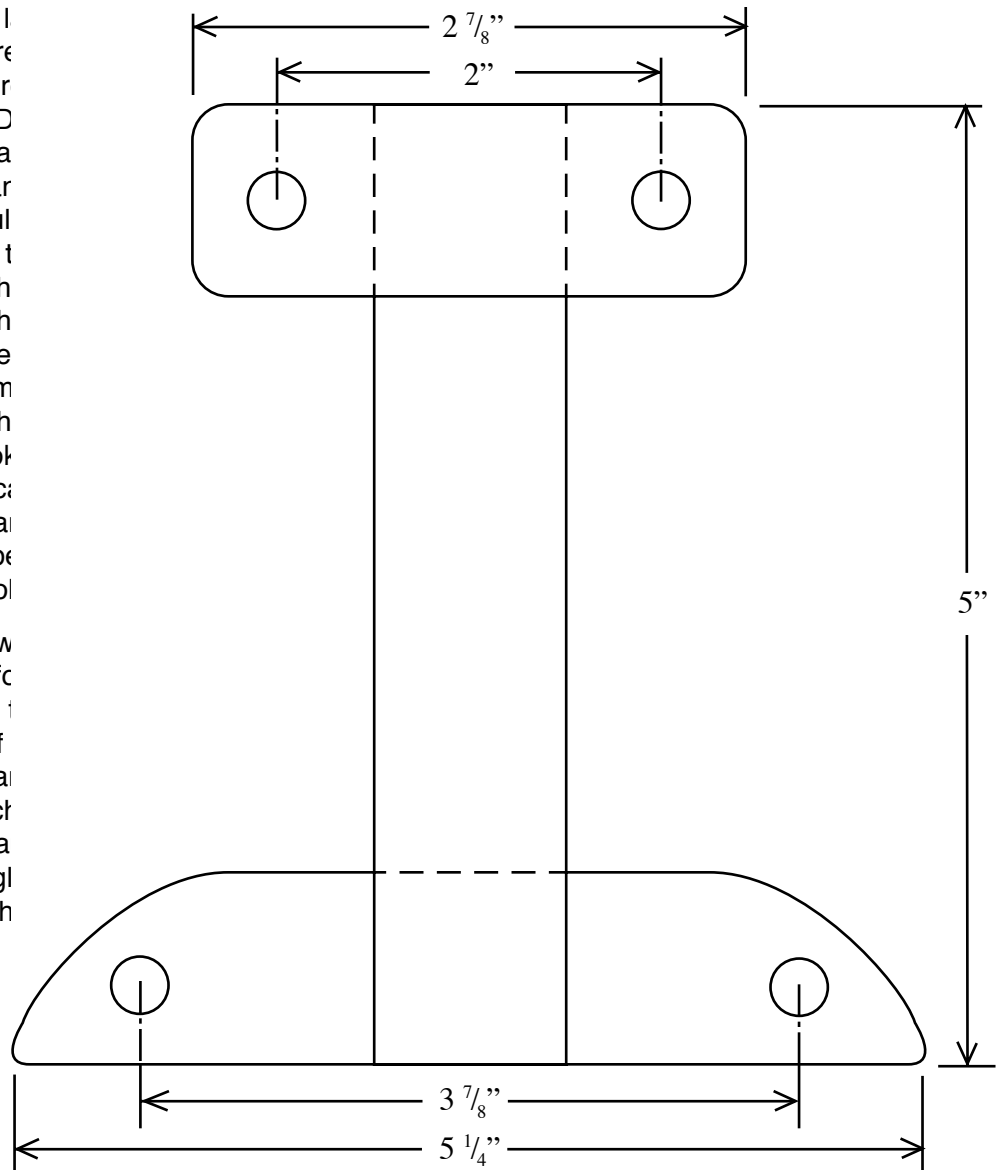

Weld top on backside and bottom on front side.

Use signal-stat lamp #2610 double filament

Wire to existing tail & stop lamp.

Unknown when first printed by the TCMG but probably in the mid 70's.

2002 Update

There are nice LED assemblies that will fit inside your "D" lamp to make it brighter and also reduce the current load. LED lamps can also be fit to the bracket above for a brighter lamp and draw less current as well.